



151 Peninsular Road Grays Point NSW

4  1  2 

Embracing a perfect north aspect & sitting close to the waters edge, this home features 4 bedrooms, open living, eat-in kitchen & double garage.

This totally original home suits a full renovation or rebuild & offers the rare opportunity to create the best lifestyle for you & the kids. Land size is 1195sqm & over 25m frontage to waterfront. First time offered in approximately 45 years.

Land Size : 1195 sqm

View : <https://www.burraneer.com.au/sale/nsw/sutherlandland/grays-point/residential/house/5719301>



Adam Payne
02 9523 8333

Grays Point

151 Peninsular Road



Ground Floor



Lower Ground Floor

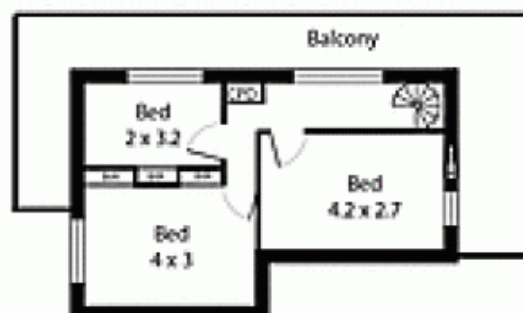

Burraneer
Real Estate Solutions

Please note: all stated dimensions are approximate only. Particulars given are for general information only and do not constitute any representation on the part of the vendor or agent.